



# What Really Works With Exceptional Learners

Today’s teachers, especially the many who work with students with special needs, are pressed to know a little something about everything. Expertise is needed in different content and pedagogical areas, but knowledge of different types of disabilities is needed as well. What Really Works With Exceptional Learners is full of evidence-based practices to empower any educator. This training will help examine how special educational needs affect content areas like reading and math, specialization areas like autism and learning disabilities, pedagogical areas like culturally responsive practices and accommodations and other critical areas like legal issues, behavior challenges, and home-school collaboration.

Presenter: Dr. Tamarah Ashton, CSUN Professor and 2Teach, LLC Associate

**Who Should Attend:** General and special education teachers, curriculum coaches, instructional specialists, and administrators.

**DATE:** Tuesday, November 27, 2018

**LOCATION:** Riverside County Office of Education  
Conference Center  
3958 Twelfth Street  
Riverside, CA 92501  
(Map on reverse.)

**TIME:** 8:30 a.m. – 3:00 p.m.

**ATTENDEE LIMIT:** 78

**REGISTRATION FEE:** \$150  
(Includes meals and materials.)

**DEADLINE:** Tuesday, November 13, 2018

**Note:** No refunds after deadline date. No refunds for no-show participants.  
All cancellations must be made in writing before the deadline date.

Online registration is available at <http://rcoe.k12oms.org/>.  
For additional information, please contact: Princess Solomon, Administrator, (951) 826-6304



## What Really Works With Exceptional Learners

Tuesday, November 27, 2018

Name: \_\_\_\_\_ Phone: \_\_\_\_\_

School: \_\_\_\_\_ District: \_\_\_\_\_

Address: \_\_\_\_\_ E-mail: \_\_\_\_\_

**REGISTRATION FEE:** \$150

**LIMIT:** 78

**DEADLINE:** Tuesday, November 13, 2018

**MAKE PAYMENT PAYABLE TO:** Riverside County Office of Education

**MAIL OR FAX TO:** Riverside County Office of Education  
Attn: Princess Solomon, Administrator  
P.O. Box 868  
Riverside, CA 92502-0868  
Fax: [951] 826-6937

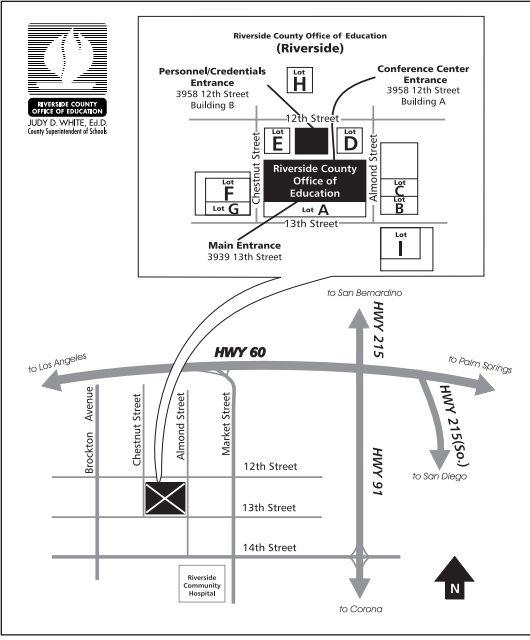

Riverside County Office of Education  
P.O. Box 868  
Riverside, CA 92502-0868